



Capacitive Sensors

Series 80 - PNP

Housing $\varnothing = 26 \text{ mm} / 1" / 40 \text{ mm}$

- Housing material PTFE
- Useable for an ambient temperature up to $+100^\circ \text{C}$
- SIP / CIP 121°C
- With Triclamp process connection
- Withflange connector M 12 x 1

Certificate:



Technical data	Non-flush mountable
Operating distance S_n	5 mm
Operating distance min./max. adjustable	0...20 mm
Electrical version	4-pin DC
Output	Antivalent (NO + NC)
Type NPN	
Art.-No.	
Connection diagram No..	
Type PNP	KAS-80-26-A-PTFE-Tri-100°C-Y5
Art.-No.	KA 0662
Connection diagram No.	6
Operating voltage (U_B)	10...35 V DC
Output current max. (I_o)	2 x 250 mA
Load current min.	-
Voltage drop max. (U_d)	$\leq 2.0 \text{ V}$
Permitted residual ripple max.	10%
No-load current (I_o)	Typ. 15 mA
Frequency of operating cycles max.	50 Hz
Permitted ambient temperature	$-25...+100^\circ \text{C} /$ CIP 121°C (zero-current)
LED-display	Green/yellow
Protective circuit	Built-in
Degree of protection IEC 60529	IP 67
Norm	EN 60947-5-2
Connection	Flange connector M 12 x 1
Housing material	PTFE (FDA 21 CFR 177.1550)
Active surface	PTFE (FDA 21 CFR 177.1550)
Lid	PA

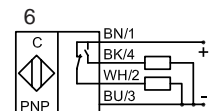
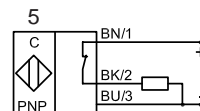
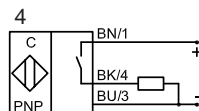
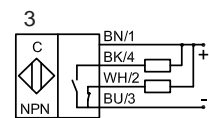
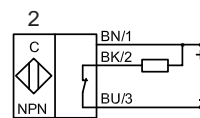
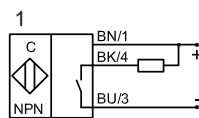
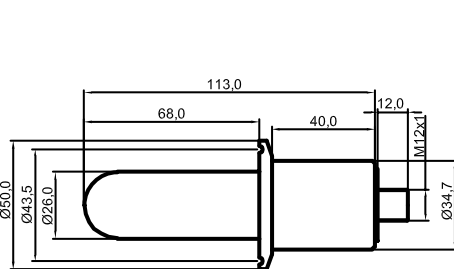

Made in Germany

All specifications are subject to change without notice. (26.01.2009)